

Total control

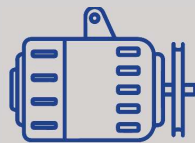

Asynchronous alternator

**SUPER
SILENCED**

Soundproof canopy

Compact and resistant engine driven welder suitable for frequent handling. Equipped with Yanmar 1500 RPM engine, it's fitted for remote control operation.

Asynchronous alternator for a better welding current quality, clean and distortion free wave form.

Just like all GenSet engine driven welders, it is designed to be used as both a generator and welder simultaneously, its simple and smart design allows a practical and easy use.



MPM 16/400 SS-Y STANDARD EQUIPMENT



MPM 16/400 SS-Y



Shielded Metal Arc Welding (SMAW)
Carbon Arc Gouging (CAG)
Tig Lift Arc Welding (TIG)

- Arc Force Control
- Remote control socket
- Carbon Arc Gouging (CAG) socket
- CC/CV switch
- Tig/Stick switch
- Low-High amps switch for a more accurate arc control
- Auto engine protection shutdown system with warning lights in case of:
 - battery charger failure
 - low fuel level
 - low oil pressure
 - high coolant temperature
- Starting battery
- Emergency stop button
- Fuel level gauge
- Hourmeter
- Voltmeter
- 2 x 32 A - 230 V single-phase sockets
- 1 x 32 A - 400 V three-phase socket
- 48 V output
- Earth leakage circuit breaker (ELCB)
- Power output protections
- Central lifting hook
- Fork lift pockets

DIMENSIONS IN MM

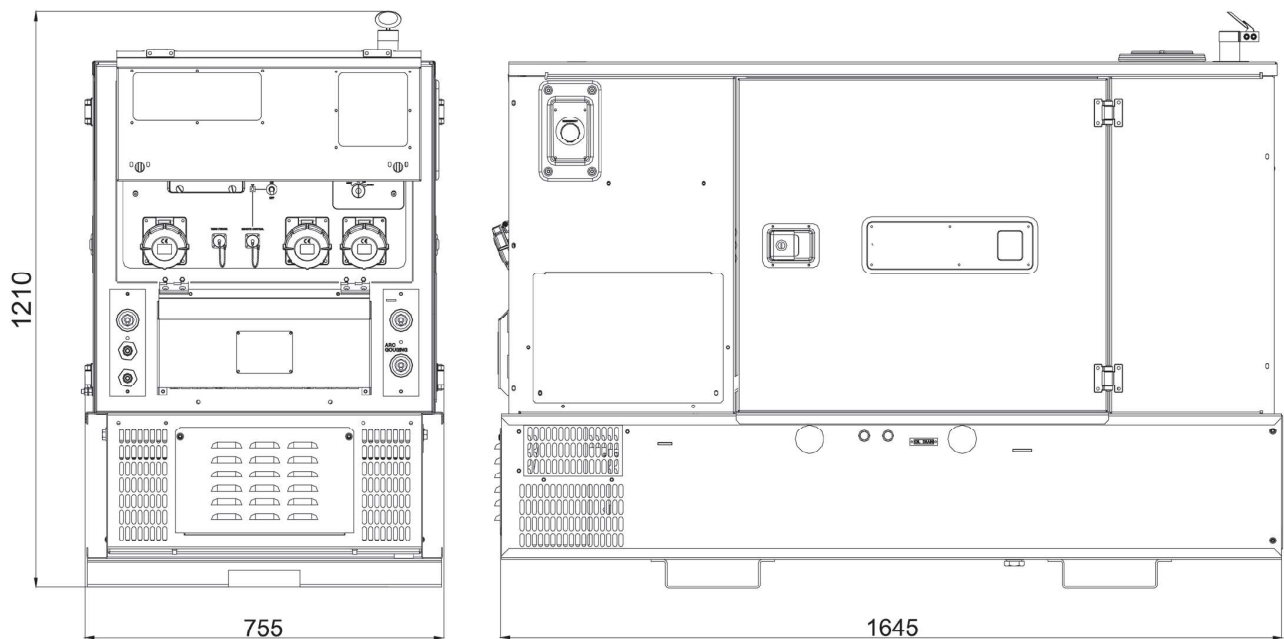

MPM 16/400 SS-Y	
Noise level Lwa	94 (69 dB a 7 mt)
AC generator-50Hz	Asynchronous
Three-phase max. power	16 kVA - 400 V
Single-phase max. power	5,3 kVA - 230 V
Single-phase max. power	5 kVA - 48 V
Power Factor	cos ϕ 0,8
DC welding	Electronic current regulation
Duty Cycle @ 60%:	400 A - 36 V
Output range:	30 A - 400 A
Open Circuit Voltage:	70 V
Max welding rod:	8 mm
1500 RPM engine	Yanmar 4 TNV 88
Fuel	Diesel
No. cylinders	4
Power	24,1 HP (18 kWm)
Displacement	2190 cm ³
Cooling system	Water
Starting system	Electric
Fuel tank capacity	70 lt
Fuel consumption @75%	3,5 lt/h
Insulation Class	H
Ambient temperature	40 °C
Altitude	1000 mt
Degree of protection	IP 23
Dimensions (LxWxH)	1645x755x1210 mm
Dry weight	700 kg



MPM 16/400 SS-Y

Options on request

- Spark arrester muffler
- Built-in polarity reversing switch
- Tig Booster welding

Accessories

- 1- ST50 Welding cables with accessories
- 2- Reverse polarity switch kit (separate)
 - 3- Welding remote control
- 4- MIG wire feeder with 10 mt connection cable
- 5- Parallel welding box with ammeter and voltmeter (P-BOX)
 - GRT2W: 2 wheels site trailer
 - GRT4W: 4 wheels site trailer



NOTE

